

Signing in to Chrome

1. If you are not signed in to Chrome you will see this icon in the top right of the Chrome browser. Click on the icon.

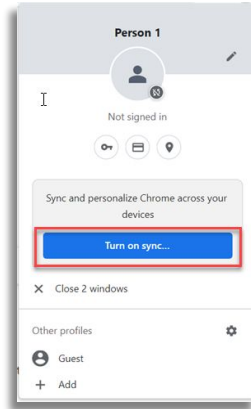

2. Click Turn on sync...



3. Enter your apps email address:

firstname.lastname@apps.wylieisd.net

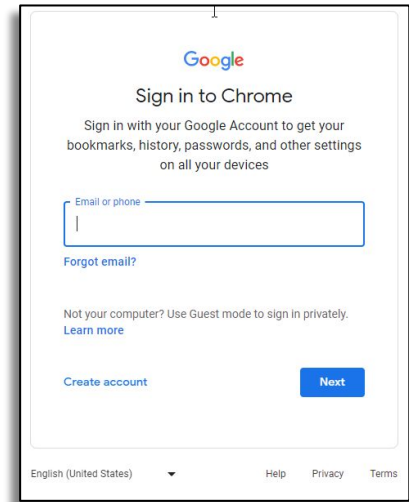

4. Sign in with your username@wylieisd.net

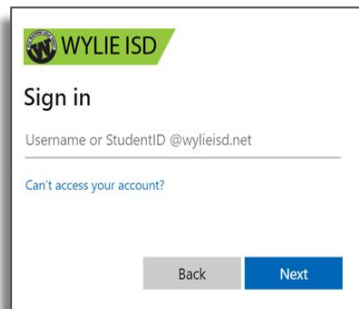

5. Enter your password

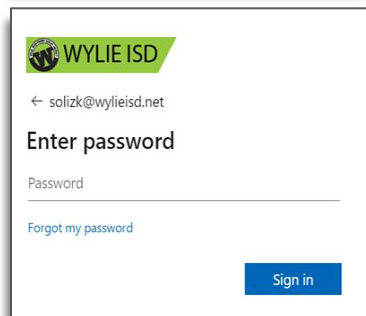

6. Clicking yes here will sync your bookmarks and passwords that you have saved in Google.

